



■ Operating Condition

Size Range : 10A~50A ($\frac{3}{8}$ "~2")
 Max. Pressure : 40kg/cm² (560PSI)
 Max. Temperature :
 100°C (210°F) NBR Packing
 180°C (360°F) Viton Packing
 Media : Air, Oil, Water

■ Features / 특징

- O-ring Seal
- Double row steel balls, supporting pressure compensation
- Extended service life by Precision processing
- Series KJ300은 O-Ring Seal 형식이며 압력에 대한 보상은 2줄 강구에 의해 지지되며 특히 정밀가공으로 안정된 수명을 보장합니다.

KJ300

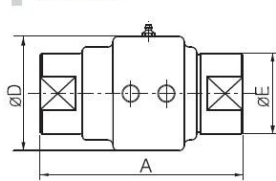

Type A

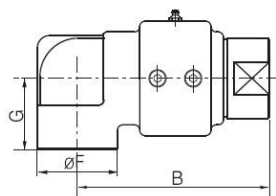

Type C

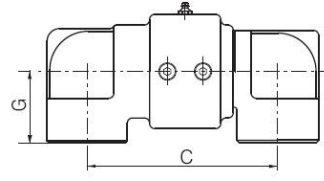

Type D

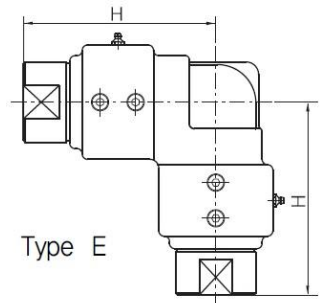

Type E

[unit : mm]

| Nominal Size | A | B | C | D | E | F | G | H | Weight(kg) | | | | |
|--------------|--------|-----|-----|-----|-----|----|----|----|------------|--------|--------|--------|-----|
| | | | | | | | | | Type A | Type C | Type D | Type E | |
| 10A | 3/8" | 86 | 73 | 74 | 48 | 34 | 30 | 30 | 73 | 0.7 | 0.7 | 0.8 | 1.2 |
| 15A | 1/2" | 86 | 73 | 74 | 48 | 34 | 30 | 30 | 73 | 0.7 | 0.7 | 0.8 | 1.2 |
| 20A | 3/4" | 114 | 108 | 107 | 64 | 48 | 45 | 40 | 108 | 1.7 | 2.0 | 2.1 | 3.1 |
| 25A | 1" | 114 | 108 | 107 | 64 | 48 | 45 | 40 | 108 | 1.5 | 1.8 | 2.1 | 3.1 |
| 32A | 1-1/4" | 117 | 114 | 110 | 78 | 66 | 60 | 50 | 114 | 2.5 | 3.2 | 3.9 | 4.3 |
| 40A | 1-1/2" | 117 | 114 | 110 | 78 | 66 | 60 | 50 | 114 | 2.2 | 2.7 | 3.2 | 4.1 |
| 50A | 2" | 150 | 145 | 156 | 100 | 80 | 76 | 60 | 145 | 4.8 | 5.5 | 7.3 | 9.5 |