



### ■ Operating Condition

Size Range : 10A~50A ( $\frac{3}{8}$ "~2")  
 Max. Pressure : 210kg/cm<sup>2</sup> (3000PSI)  
 Max. Temperature :  
     100°C (210°F) NBR Packing  
     180°C (360°F) Viton Packing  
 Media : Air, Oil, Water, Hydraulic Oil

### ■ Features / 특징

- Special Packing Seal
- Double row steel balls supporting pressure compensation
- Low Torque at High Pressure
- Series KJ400은 특수팩킹 Seal 형식이며 압력에 대한 보상은 2줄 강구에 의해 지지되며 고압에서도 낮은 Torque가 특징입니다.

### KJ400

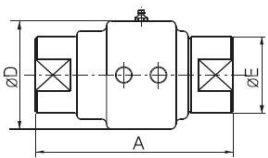

Type A

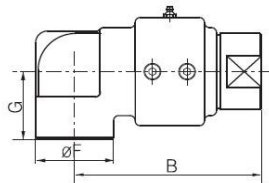

Type C

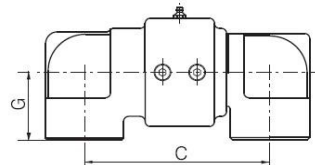

Type D

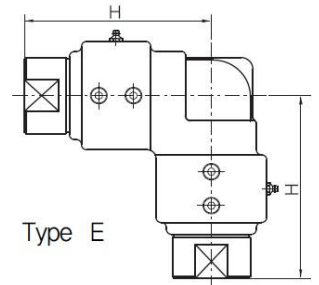

Type E

[unit : mm]

| Nominal Size | A      | B   | C   | D   | E   | F  | G  | H  | Weight(kg) |        |        |        |     |
|--------------|--------|-----|-----|-----|-----|----|----|----|------------|--------|--------|--------|-----|
|              |        |     |     |     |     |    |    |    | Type A     | Type C | Type D | Type E |     |
| 10A          | 3/8"   | 86  | 73  | 74  | 48  | 34 | 30 | 30 | 73         | 0.7    | 0.7    | 0.8    | 1.2 |
| 15A          | 1/2"   | 86  | 73  | 74  | 48  | 34 | 30 | 30 | 73         | 0.7    | 0.7    | 0.8    | 1.2 |
| 20A          | 3/4"   | 114 | 108 | 107 | 64  | 48 | 45 | 40 | 108        | 1.7    | 2.0    | 2.1    | 3.1 |
| 25A          | 1"     | 114 | 108 | 107 | 64  | 48 | 45 | 40 | 108        | 1.5    | 1.8    | 2.1    | 3.1 |
| 32A          | 1-1/4" | 117 | 114 | 110 | 78  | 66 | 60 | 50 | 114        | 2.5    | 3.2    | 3.9    | 4.3 |
| 40A          | 1-1/2" | 117 | 114 | 110 | 78  | 66 | 60 | 50 | 114        | 2.2    | 2.7    | 3.2    | 4.1 |
| 50A          | 2"     | 150 | 145 | 156 | 100 | 80 | 76 | 60 | 145        | 4.8    | 5.5    | 7.3    | 9.5 |