



■ Operating Condition

Size Range : 10A~40A ($\frac{3}{8}$ "~ $1\frac{1}{2}$ "")
 Max. Pressure : 400kg/cm² (5600PSI)
 Max. Temperature : 100°C (210°F)
 Media : Water

■ Features / 특징

- Electroless Nickle Plated body and Stainless steel shaft
- High pressure watering
- 무전해 니켈도금 바디와 스테인리스 스틸 축으로 구성되어 내부식성이 탁월합니다.
- 고압 살수용으로 적합합니다.

KJ410

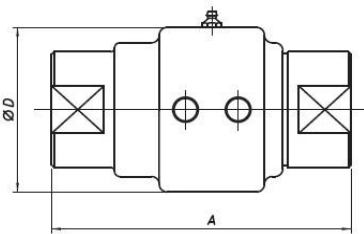

Type A

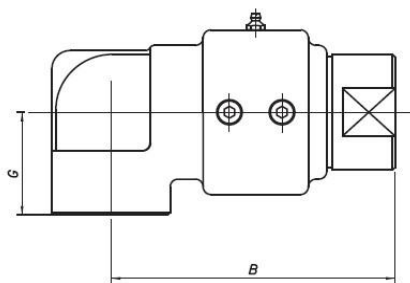

Type C

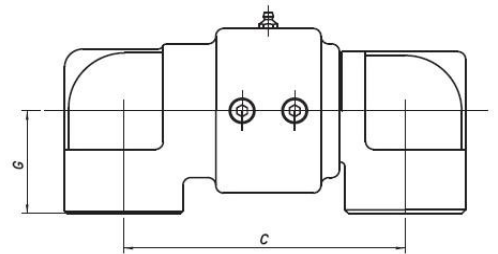

Type D

[unit : mm]

Nominal Size		A	B	C	D	G	Weight(kg)		
							Type A	Type C	Type D
10A	3/8"	86	73	74	48	30	0.8	0.8	0.9
15A	1/2"	86	73	74	48	30	0.8	0.8	0.9
20A	3/4"	114	108	117	73	40	1.8	2.1	2.3
25A	1"	114	108	117	73	40	1.7	1.9	2.2
32A	1-1/4"	117	129	140	80	50	2.5	3.3	4.0
40A	1-1/2"	117	129	140	80	50	2.1	2.7	3.3