



■ Operating Condition

Size Range : 50A~150A (2"~6")
 Max. Pressure : 210kg/cm² (3000PSI)
 Max. Temperature :
 100°C (210°F) NBR Packing
 180°C (360°F) Viton Packing
 Media : Air, Oil, Water, Hydraulic Oil

■ Features / 특징

- Pressure Balance Type
- Low Torque at High pressure
- Extended service life
- Series KJ600은 압력밸런스 타입으로 고압에서 낮은 Torque와 제품의 긴 수명이 특징입니다.

KJ600

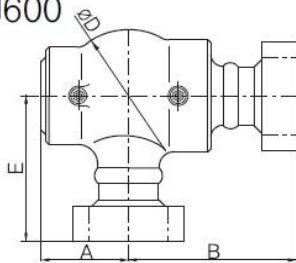

Type C

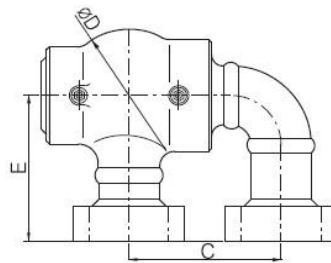

Type D

[unit : mm]

Nominal Size		A	B	C	D	E	Weight(kg)	
							Type C	Type D
50A	2"	88	200	153	136	170	33.0	34.0
65A	2-1/2"	103	220	184	166	185	48.0	49.5
80A	3"	109	240	207	173	200	57.0	60.0
100A	4"	141	270	274	206	235	87.0	92.5
125A	5"	155	310	324	295	300	159.0	169.0
150A	6"	195	450	400	370	430	240.0	256.0