



ROTARY JOINT - SERIES 6314-20 / 6313-20



Operating Condition

- Max. Coolant Pressure : 105bar (1,520PSI)
- Max. Rotation Speed : 20,000/min (20,000RPM)
- Max. Temperature : 80°C (180°F)
- Media : Coolant, Hydraulic Oil

* Refer to graph for maximum pressure and speed combination

* Avoid max. pressure at max. rpm operation

Features

- For high speed machining centers
- Dry running at high speed without coolant pressure
- Other port size and connection unions are available on order demand

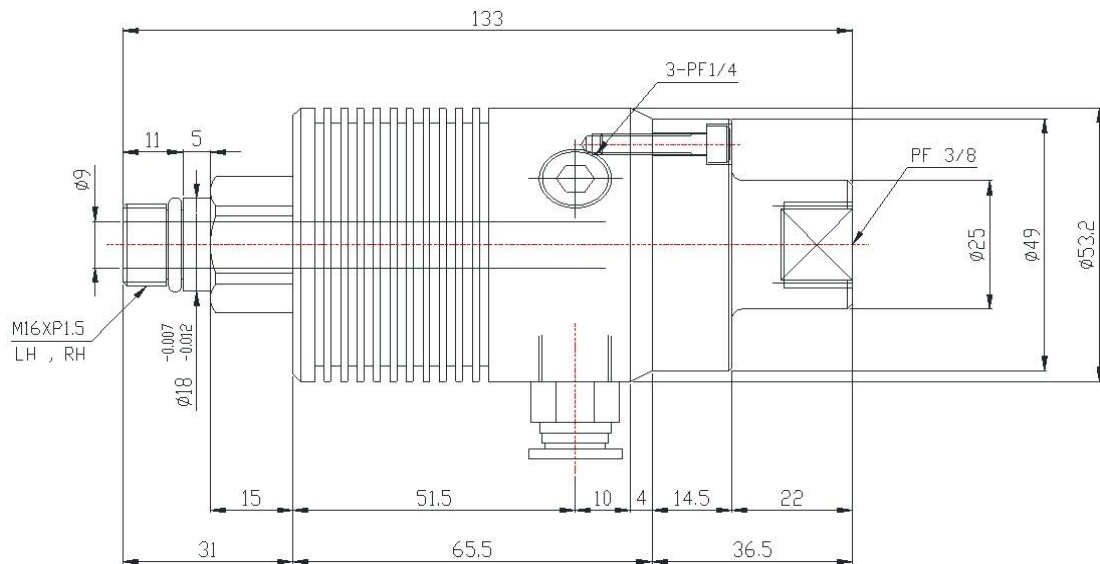
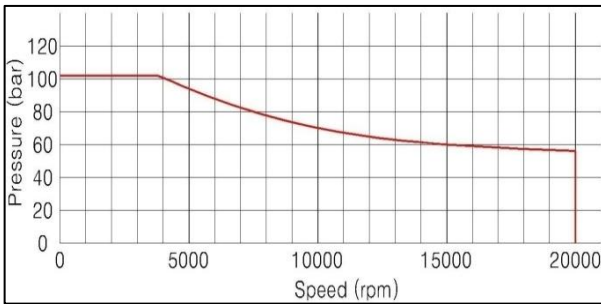

KR6314-20-A (LH) / KR6313-20-A (RH)

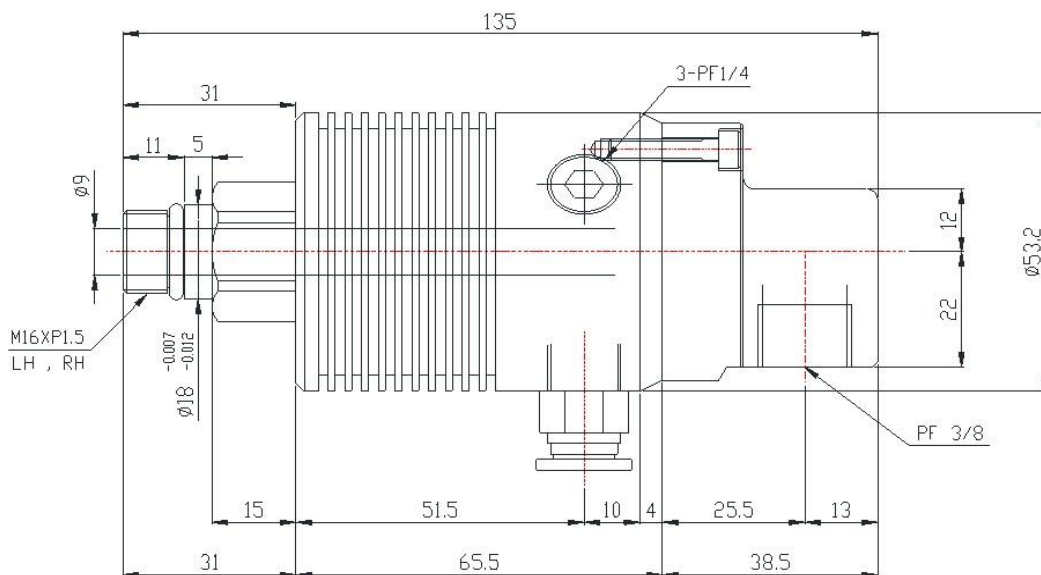

KR6314-20-R (LH) / KR6313-20-R (RH)