

## K35-TYPE

## Planetary GEARHEAD

### DIMENSIONS

#### K35-3640 BLDC SERIES

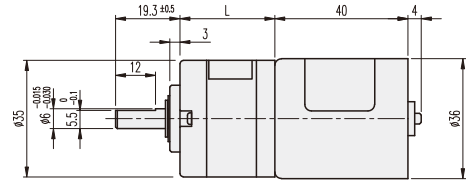
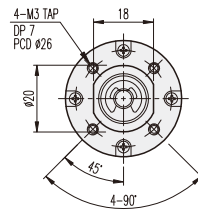

GEARHEAD LENGTH

RATIO	L
1/005	22.1
1/014 ~ 1/027	28.5
1/051 ~ 1/139	34.9
1/189 ~ 1/721	41.3

#### BLDC MOTOR PERFORMANCE DATA

MODEL	ITEM	VOLTAGE (DC)	NO LOAD		AT MAX. EFF.			WEIGHT (g)
			mA	rpm	gf-cm	A	rpm	
NB3640S1		12V	500	5300	150	1.2	4500	150
NB3640S2		24V	300	5000	250	0.8	3900	

#### AT MAXIMUM EFFICIENCY (K35-□□□-NB3640S□)

GEAR	MODEL	NB3640S1		NB3640S2	
		DC 12V		DC 24V	
		rpm	kgf-cm	rpm	kgf-cm
1/005		900	0.7	780	1.1
1/014		321	1.7	278	2.9
1/019		237	2.3	205	3.9
1/027		167	3.3	144	5.6
1/051		88	5.5	76	9.5
1/071		63	7.7	55	12
1/100		45	10.8	39	12
1/139		32	12	28	12
1/189		24	12	21	12
1/264		17	12	15	12
1/369		12	12	10.5	12
1/516		8.7	12	7.6	12
1/721		6.2	12	5.4	12

- \* Gearbox output shaft rotation direction is same direction with motor.
- \* Proceed function change in motor stop type.
- \* Controller for speed control is GUN type.

#### How to connect when speed control is not needed.

No - Color	Pin - Contents	Connection Method
1 - White	Brake	No Use, (-) connectin Brake
2 - Blue	PWM	connecting to (-) power
3 - Yellow	1FG(6P/R)	No Use
4 - Orange	CW/CCW	Normal Open, CCW connecting to (-) power
5 - Black	GND	connecting to (-) power
6 - Red	24V	connecting to (+) power

\* Please be cautious that Motor can be damaged when connected to incorrect power (+) (-).

